



**272 SHADWELL LANE**  
LEEDS, LS17 8AJ

**£400,000**  
**FREEHOLD**

Take a look at this FANTASTIC development opportunity. If you are looking for a substantial plot in a prime location with an abundance of potential and separate annex then this is the property for you.

**M O N R O E**

SELLERS OF THE FINEST HOMES



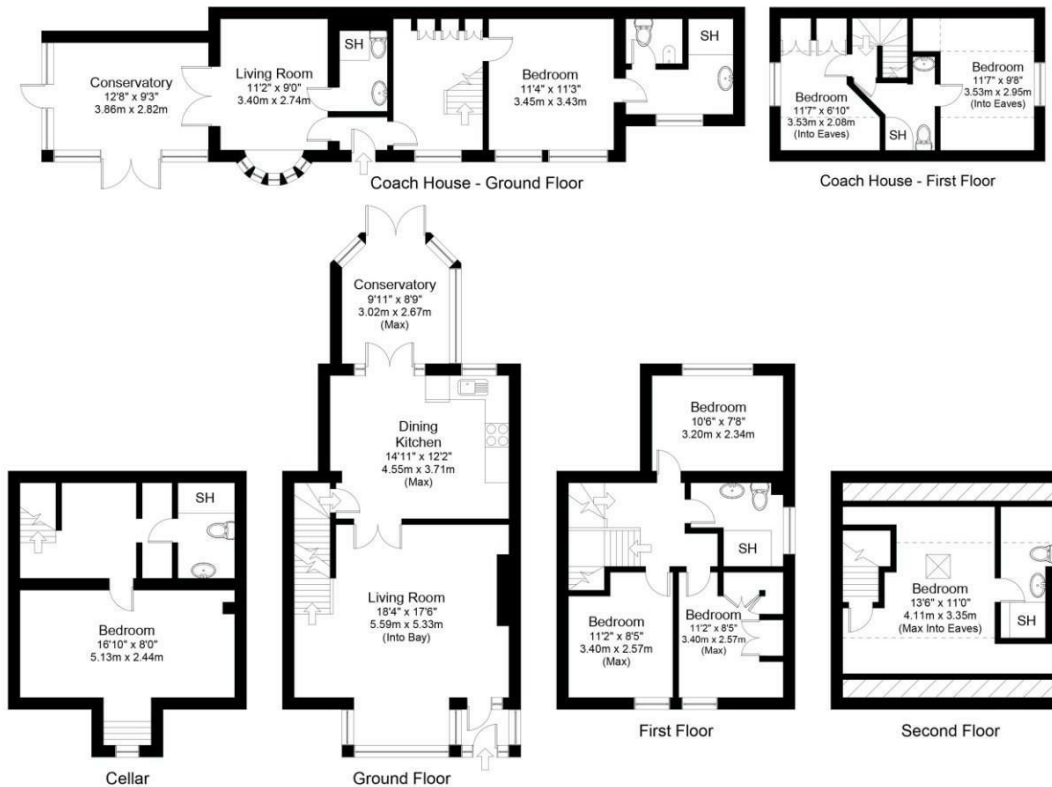

Main House - Gross internal floor area including eaves (approx.): 150.6 sq m (1,621 sq ft)

Coach House - Gross internal floor area including eaves (approx.): 78.5 sq m (845 sq ft)

For illustrative purposes only. Not to Scale. Copyright © Zenith Creations.

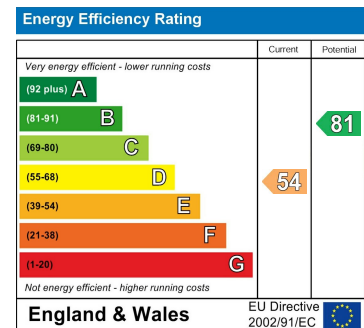

Agents Note: Whilst every care has been taken to prepare these particulars, they are for guidance purposes only. All measurements are approximate and are for general guidance purposes only and whilst every care has been taken to ensure their accuracy, they should not be relied upon and potential buyers/tenants are advised to recheck the measurements

Leeds Office Sales  
1-3 The Avenue  
Alwoodley  
Leeds  
West Yorkshire  
LS17 7BD

0113 870 4443  
hello@monroeestateagents.com  
www.monroeestateagents.com

**MONROE**

SELLERS OF THE FINEST HOMES